



THE APARTMENT COMPANY®
20TH ANNIVERSARY

2 Bedrooms

Apartment

Located in Bath

Offers Over
£425,000

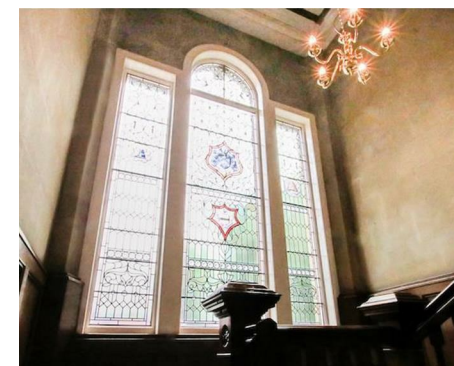

sales@theapartmentcompany.co.uk

www.theapartmentcompany.co.uk

01225 471 144



Meadow View Kelston Road

Bath BA1 3QN



OFFER OVER £425,000

Presenting this beautiful and incredibly spacious two bedroom ground floor apartment which combines light and airy rooms with grand features and spacious large double bedrooms.

It boasts ample parking and a private enclosed garden with lawn and seating area.

It is an ideal choice for those seeking convenience and quality in their next home.

For further information or to arrange a viewing please contact The Apartment Company.

Meadow View

Offers Over £425,000

- Two Double Bedrooms
- Enclosed Garden
- Ample Parking
- 1184 sq ft
- Ground Floor
- En Suite
- Light and Airy
- No Onward Chain



Meadow View, Weston, Bath, BA1 3QN
 Total Area: 1184 sq.ft. (110 sq.m.)



THE APARTMENT COMPANY®
 The Apartment Specialists

GROUND FLOOR

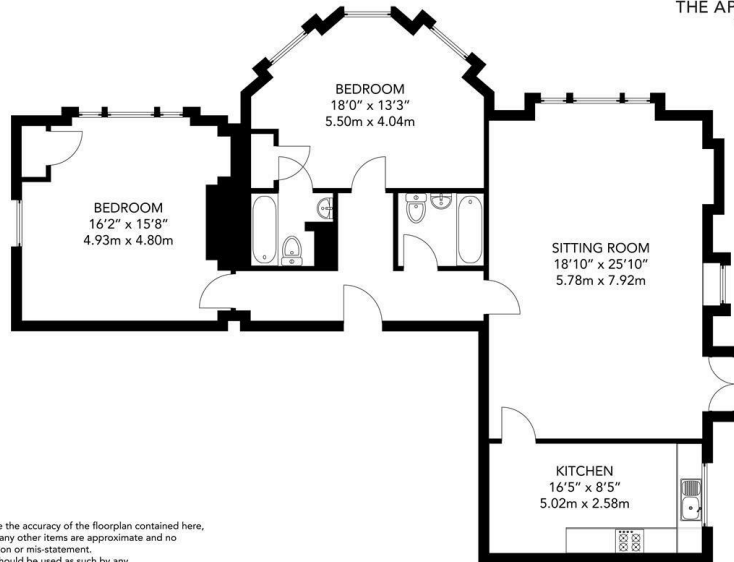

Whilst every attempt has been made to ensure the accuracy of the floorplan contained here, measurements of doors, windows, rooms and any other items are approximate and no responsibility is taken for any such error, omission or mis-statement. This plan is for illustrative purposes only and should be used as such by any prospective purchaser. The services, systems and appliances shown have not been tested and no guarantee as to their operability or efficiency can be given. Focus Property Marketing 2024



THE APARTMENT COMPANY®
 20TH ANNIVERSARY

4 Queen Street
 Bath
 BA1 1HE

01225 471 144

sales@theapartmentcompany.co.uk

Council Tax Band: D

Local Authority: Bath and North East Somerset

Agents Note: Whilst every care has been taken to prepare these particulars, they are for guidance purposes only. All measurements are approximate and are for general guidance purposes only and whilst every care has been taken to ensure their accuracy, they should not be relied upon and potential buyers/tenants are advised to recheck the measurements.

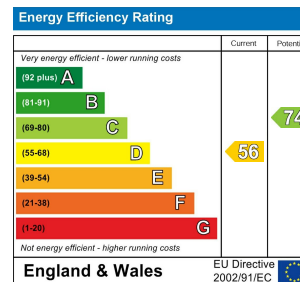

www.theapartmentcompany.co.uk